

Decorator Technical Specification

Grab Bar

YG4700

Stock Numbers:

- **YG4712CHP – 12” Grab Bar**
Chrome Finish, 1 ¼” Round Bar,
Optional Polished Brass Accent Ring
- **YG4718CHP – 18” Grab Bar**
Chrome Finish, 1 ¼” Round Bar,
Optional Polished Brass Accent Ring
- **YG4724CHP – 24” Grab Bar**
Chrome Finish, 1 ¼” Round Bar,
Optional Polished Brass Accent Ring
- **YG4730CHP – 30” Grab Bar**
Chrome Finish, 1 ¼” Round Bar,
Optional Polished Brass Accent Ring
- **YG4736CHP – 36” Grab Bar**
Chrome Finish, 1 ¼” Round Bar,
Optional Polished Brass Accent Ring

Dimensions:

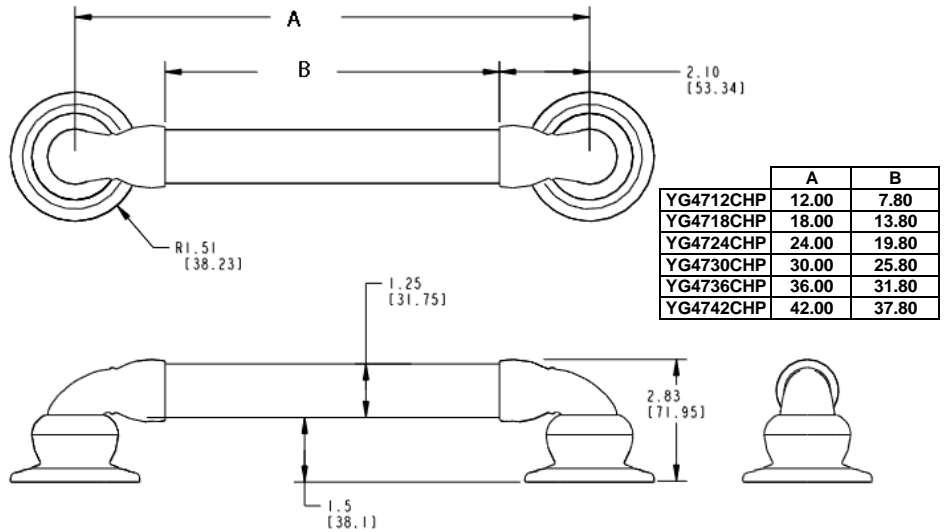

Installation Instructions:

Please note that all screws must mount into a wood stud.

1. Pull up and slide both accent rings onto the bar to expose the mounting screw holes.
2. Locate the studs behind the wall using a stud sensor or another stud locating method.
Place the grab bar on the wall where desired so that all the mounting holes are positioned over a wood stud. Use a level if desired to verify placement.
3. With a pencil, mark all 6 mounting hole locations.
4. Remove the grab bar from the wall and drill 1/8” diameter pilot holes at the six marked screw locations. Apply silicone caulk to back of hubs if desired.
5. Mount the grab bar using all 6 of the # 10 x 2 ½” long wood screws provided.
Tighten screws until secure.
6. Slide the accent rings back into place and press onto the hubs to secure.

To change the accent rings prior to installation, follow the instructions below:

1. Use a M6 metric hex wrench to loosen and remove the cap screw from the back of one hub / elbow assembly.
2. Disassemble the hub from the elbow / bar assembly. Pull up and remove the chrome accent ring from the disassembled hub. For the opposite end of the bar, pull up and slide off the chrome accent ring down the length of the bar.
3. Press one polished brass accent ring onto the disassembled hub. Slide other polished brass accent ring down the length of the bar and press onto the opposite hub.
4. Re-assemble the hub with polished brass accent ring to the elbow of the bar assembly.
Load the cap screw to the hub & tighten with the hex wrench until secure.

Cleaning Instructions:

To preserve the fine finish of this product, clean only with a soft damp cloth. Dry well. Do not use commercial or abrasive cleaners.

Materials:

Grab Bars posts are forged from aluminum. Bars are extruded aluminum. Accent Rings are stamped brass.

Compliance:

CSI grab bars meet or exceed the applicable requirements of the following standards:

ICC/ANSI A117.1

ASTM F446

CSA B45

CSA B651

Load Tested to withstand 300 lbs when securely installed per instructions.

12” long grab bars are intended for vertical installation only.

Stock Number: _____ **Grab Bar**
By Creative Specialties

25300 AL MOEN DRIVE • NORTH OLMSTED, OH 44070
CORPORATE HEADQUARTERS: (800) 321-8809 • FAX: (800) 848-6636
INTERNATIONAL: (440) 962-2000 • FAX: (440) 962-2726
CUSTOMER SERVICE (USA): 800-882-0116 • FAX: (888) 379-2720
WWW.MOEN.COM

©Copyright Creative SpecialtiesInternational

Literature #BA1109

