

DESCRIPTION

- Metal construction with various finishes identified by suffix
- Includes non-metallic showerhead, arm, flange and non-metallic diverter tub spout

OPERATION

- Handle operates counterclockwise through a 270° arc with off at 6 o'clock and maximum hot at the 9 o'clock position. Shut off in clockwise direction
- Adjustable temperature limit stop to control maximum hot water temperature
- Pressure balancing mechanism maintains selected discharge temperature to $\pm 3^\circ$

FLOW

- Showerhead is limited to 2.5 gpm (9.5 L/min) at 80 psi
- EP suffix models are limited to 1.75 gpm (6.6 L/min) at 80 psi
- NH suffix models contain no showerhead

CARTRIDGE

- 1222 cartridge design
- Accommodates back to back installations
- Nonmetallic/nonferrous and stainless steel material

STANDARDS

- Third party certified to meet ASME A112.18.1/CSA B125.1 and all applicable requirements referenced therein
- EP suffix models are third party certified to WaterSense®
- **ADA**  for lever handle

WARRANTY

- Lifetime limited warranty against leaks, drips and finish defects to the original consumer purchaser
- 5 year warranty if used in commercial installations

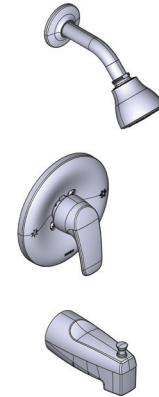

CHATEAU® POSI-TEMP® Single-Handle Tub/Shower Trim Kit

- Models:** TL5181 series - valve trim only
(Bulk Packed 12 per carton)
TL5182 series - shower trim only
(Bulk Packed 12 per carton)
TL5182NH series - shower trim only no head
(Bulk Packed 12 per carton)
TL5183 series - tub/shower trim
(Bulk Packed 12 per carton)
TL5183NH series - tub/shower trim only no head
(Bulk Packed 12 per carton)

Valves: 62300 series
2500 series

