

## DESCRIPTION

- Metal construction with various finishes identified by suffix
- For installations from 6" (152mm) to 16" (406mm) centers
- 1/2" IPS connections will accept standard ball nose connection for 3/8" tubing
- Diverter valve includes an integral vacuum breaker
- Includes metal pop-up waste assembly
- Includes valve

## OPERATION

- Lever style handles, 180° rotation
- Rotate hot side handle counterclockwise to open and clockwise to close
- Rotate cold side handle clockwise to open and counterclockwise to close
- Water flow is diverted by turning the knob counterclockwise for fill and clockwise for rosetta spray

## CARTRIDGE

- 94831 diverter cartridge
- 1224 cartridge design with nonmetallic/nonferrous and stainless steel material

## STANDARDS

- Third party certified to ASME A112.18.1/CSA B125.1 and all applicable requirements referenced therein
- ADA ♿ for lever handles

## WARRANTY

- Lifetime limited warranty against leaks, drips and finish defects to the original consumer purchaser
- 5 year warranty if used in commercial installations

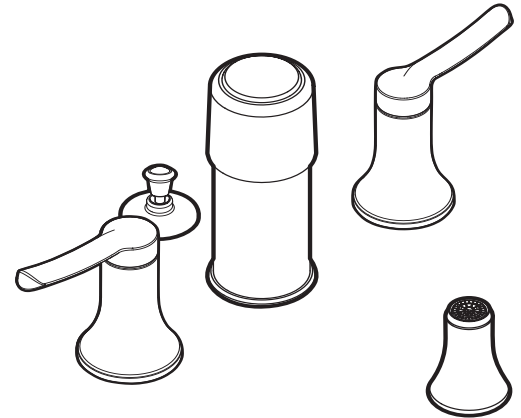

**Fina™**  
**Two-Handle Bidet Faucet**

**Models: S41705 Series**

**NOTE:** Cannot be used with Non Rim Flush Bidet Fixtures

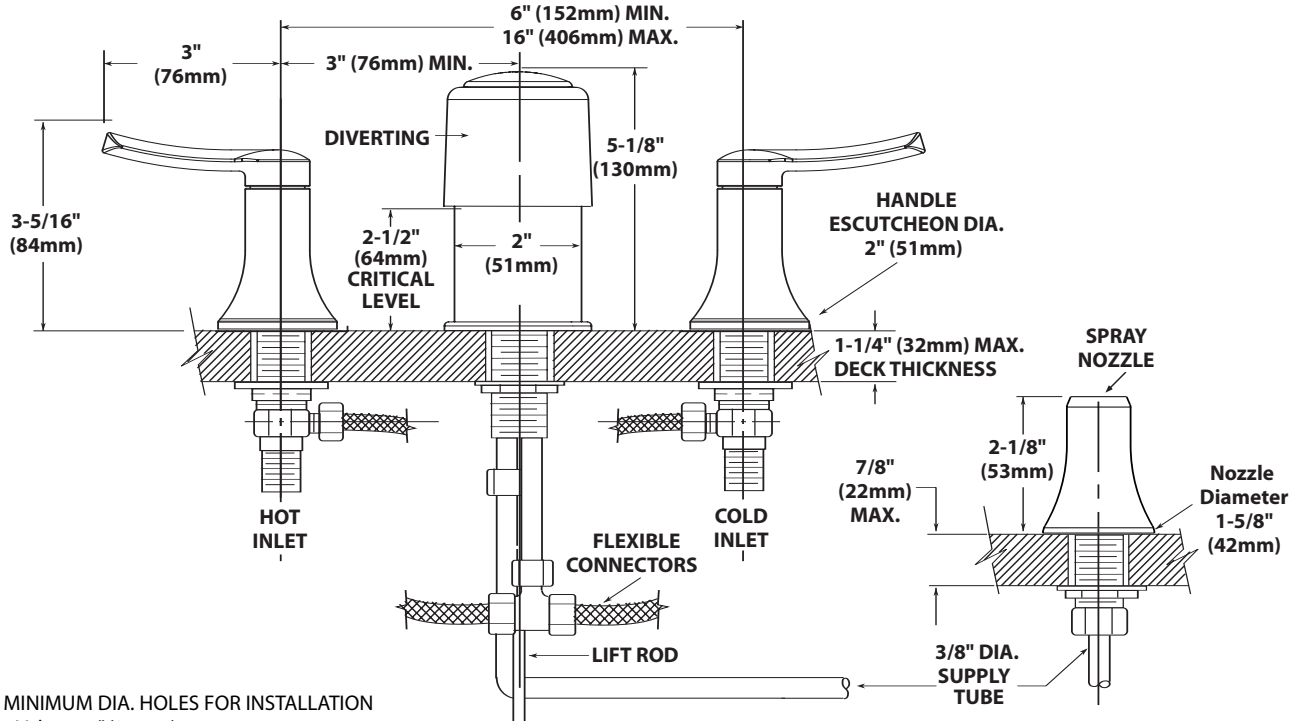

**NOTE:** MINIMUM DIA. HOLES FOR INSTALLATION  
Diverter Valve = 1" (25mm)  
Handle Valves = 1-1/8" (29mm)  
Spray Nozzle = 5/8" (16mm)  
Lift Rod Escutcheon = 1/2" (13mm)

## CRITICAL DIMENSIONS

(DO NOT SCALE)