

FAUCET DESCRIPTION

- Metal construction with various finishes identified by suffix
- Includes plastic pop-up type waste assembly
- Flexible supply lines with 3/8" fittings connect directly to supply stops

OPERATION

- Pivot action lever style handle

FLOW

- Water usage is limited to these maximum flow rates as indicated by the corresponding product markings
 - ° 1.2 gpm max (4.5L/min) at 60 psi

CARTRIDGE

- 1255™ Duralast™ cartridge for Single-Handle Faucets
- Engineered polymers, non-ferrous and stainless steel materials

STANDARDS

- Third party certified to WaterSense,® ASME A112.18.1/CSA B125.1, and all applicable requirements referenced therein
- Certified to NSF 61/9 & 372
- Products marked with 1.2 gpm are compliant with California water efficiency regulations
- Complies with California Proposition 65 and with the Federal Safe Drinking Water Act

- **ADA**  for lever handle

WARRANTY

- Lifetime limited warranty against leaks, drips and finish defects to the original homeowner
 - 10 year limited warranty when used in a multifamily installation
 - 5 year limited warranty when used in a commercial installation
- Visit www.moen.com/support for complete details and limitations

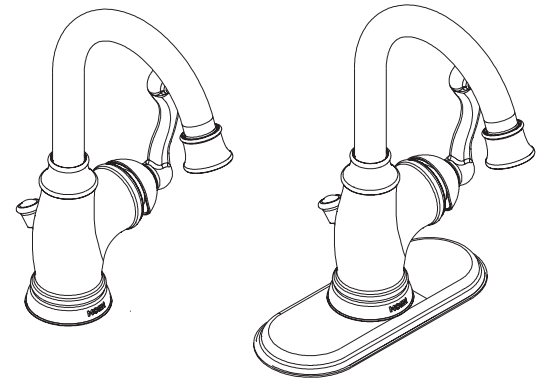

Single-Handle Lavatory Faucet

Models: 84007 series

NOTE: THIS FAUCET IS DESIGNED TO BE INSTALL THROUGH 1 OR 3 HOLES 1-1/4" (32mm) MIN. DIA.

