

ORDER BY PART NUMBER

### Jaslynn™ MotionSense Wave™ Hands-Free, Single-Handle High arc Pulldown Kitchen Faucet 87618EW Series

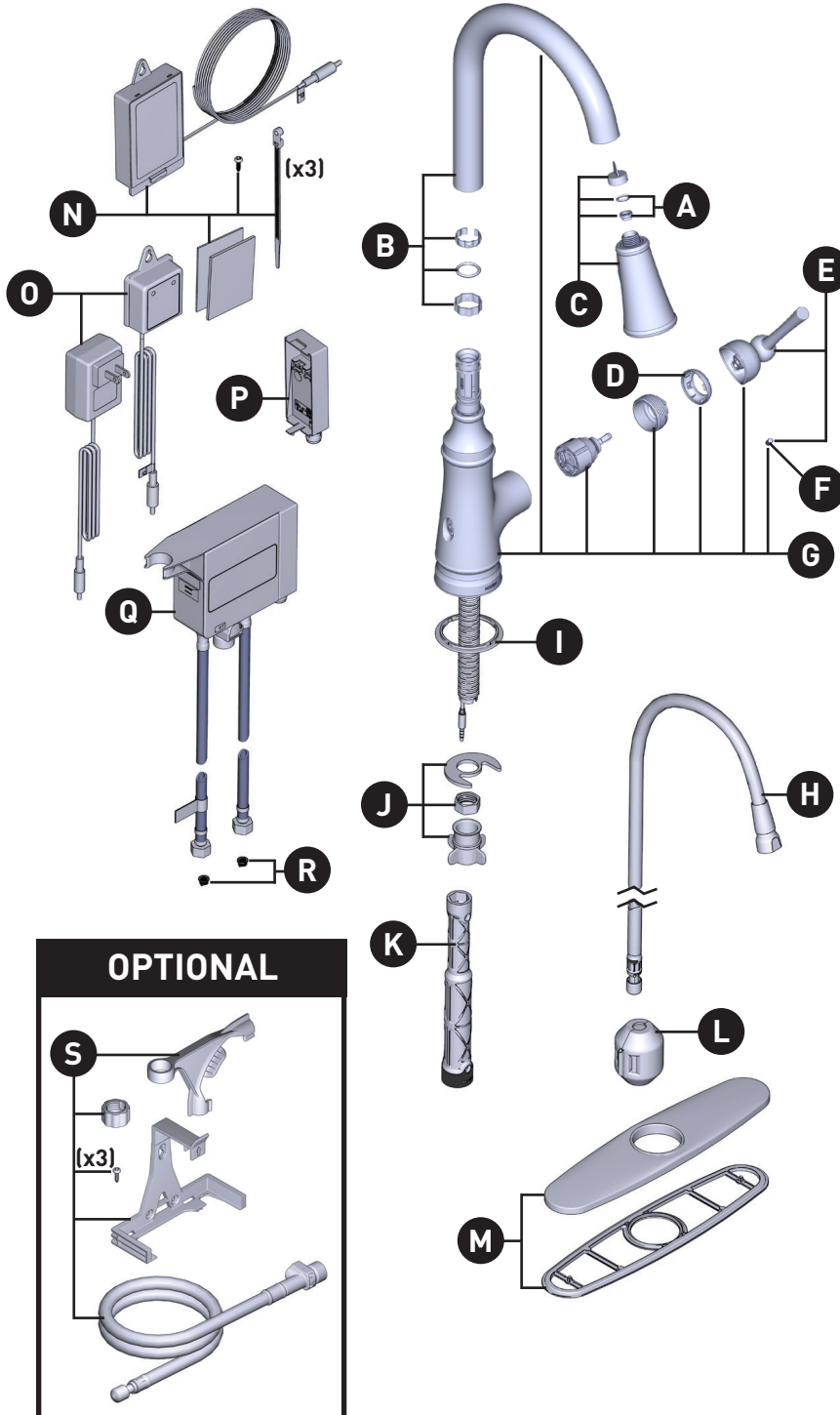

| ID | Kit Number | Finish                       |
|----|------------|------------------------------|
| A  | 158550     | N/A                          |
| *B | 176078     | See Below                    |
| *C | 221928     | See Below                    |
| *D | 160660     | See Below                    |
| *E | 221926     | See Below                    |
| F  | 155023     | N/A                          |
| *G | 221934     | See Below                    |
| H  | 150259     | N/A                          |
| I  | 143338     | Used for Chrome, BZG and SRS |
|    | 143338BL   | Used for BL and BRB          |
| J  | 193774     | N/A                          |
| K  | 118305     | N/A                          |
| L  | 125989     | N/A                          |
| *M | 141002     | See Below                    |
| N  | 177567     | N/A                          |
| O  | 169031     | N/A                          |
| P  | 188031     | N/A                          |
| Q  | 177569     | N/A                          |
| R  | 197171     | N/A                          |
| S  | 177566     | N/A                          |

**\*Finish Determined by Suffix**

| Finish    | Description           |
|-----------|-----------------------|
| No Suffix | Chrome                |
| BL        | Matte Black           |
| BRB       | Mediterranean Bronze  |
| BZG       | Bronzed Gold          |
| SRS       | Spot Resist Stainless |