

ENGAGE™ POSI-TEMP® Single-Handle Magnetix™ Rainshower Combo 82304 Series

ORDER BY PART NUMBER

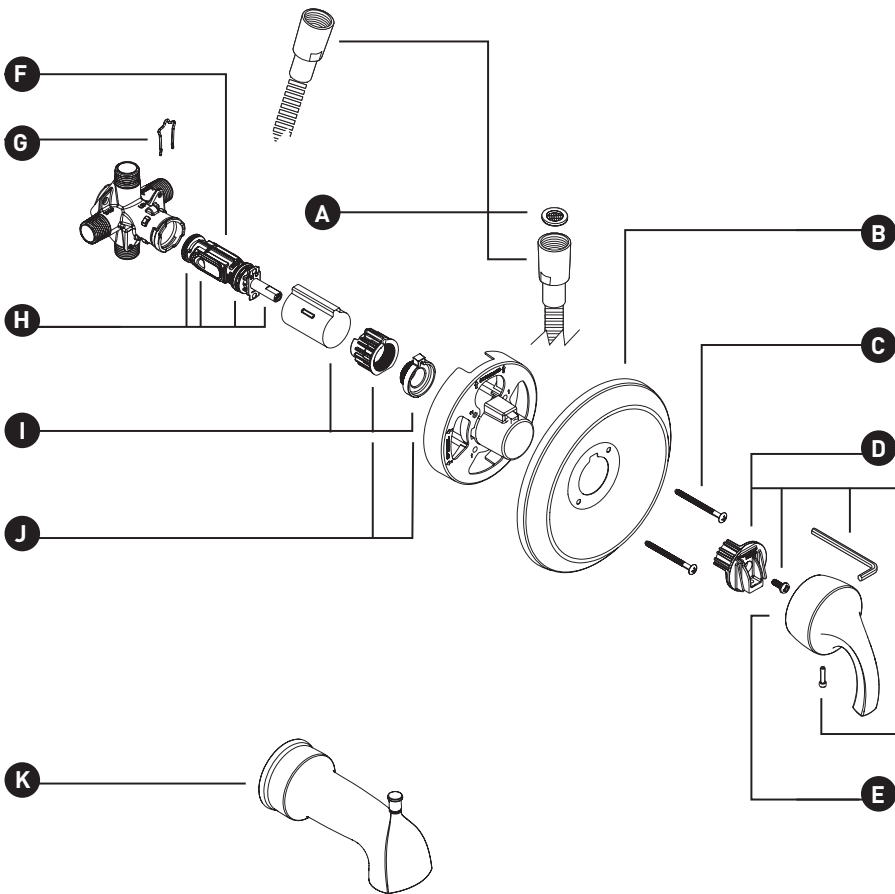

ID	Kit Number	Finish
*A	170930	See below
*B	186695	See below
C	15528	(Used for Chrome)
	163WR	(Used for Matte Black)
	163BN	(Used for Spot Resist Brushed Nickel)
D	116653	N/A
*E	186696	See below
F	1222	N/A
G	96914	N/A
H	96988	N/A
I	96987	(Used for Chrome and Spot Resist Brushed Nickel)
	96987WR	(Used for Matte Black)
J	106479	N/A
*K	186697	See below
L	188411	N/A

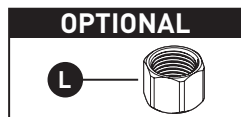

*Finish Determined by Suffix	
<u>Finish</u>	<u>Description</u>
No Suffix	Chrome
BL	Matte Black
SRN	Spot Resist Brushed Nickel