

Kyvos™

Single-Handle Roman Tub Faucet
Trim with Handheld Shower

MODELS: T907 Series

ORDER BY PART NUMBER

Trim can be used with 4791 valve

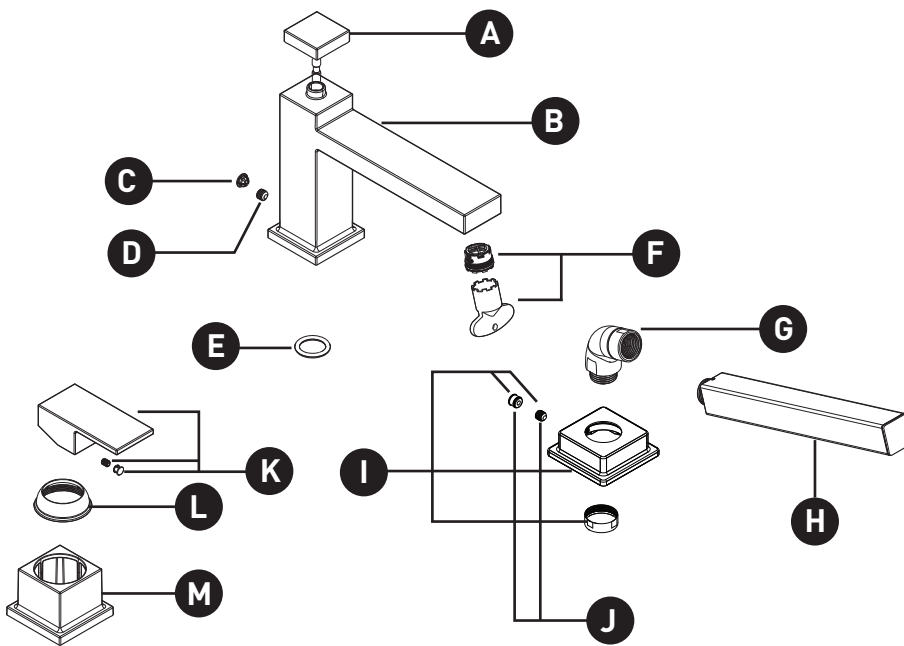

ID	Kit Number	Finish
*A	193159	See Below
*B	193174	See Below
C	1512	Chrome
	1512WR	(Used for Matte Black)
	1512BN	Brushed Nickel
	1512BZG	Bronzed Gold
D	99892	N/A
E	117	N/A
F	128884	N/A
*G	141798	See Below
*H	189575	See Below
*I	147567	See Below
*J	147575	See Below
*K	193157	See Below
*L	184616	See Below
*M	193158	See Below

*Finish Determined by Suffix	
Finish	Description
No Suffix	Chrome
BL	Matte Black
BN	Brushed Nickel
BZG	Bronzed Gold