

There is more than 1 version of this model.  
Page down to identify the version you have.

■ Order by Part Number

DARCY™ Two-Handle Widespread Lavatory Faucet		
MODEL	FINISH	NOTES
84551	Chrome	Non-Metallic Waste
84551SRN	Spot Resist Brushed Nickel	Non-Metallic Waste

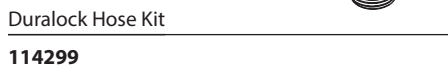
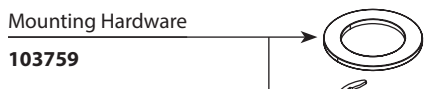
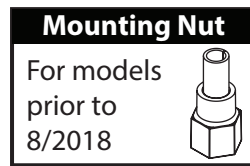
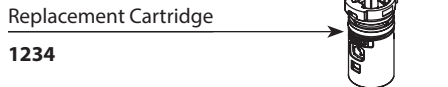
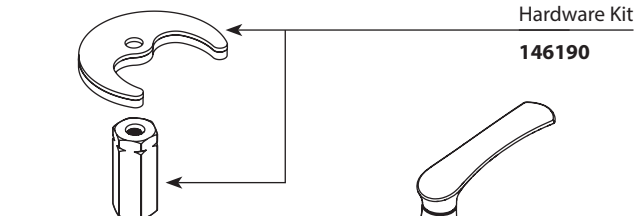
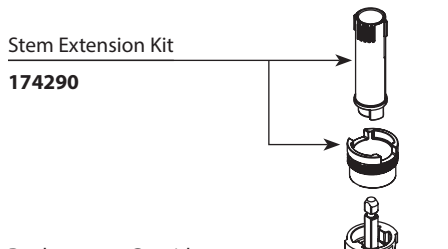
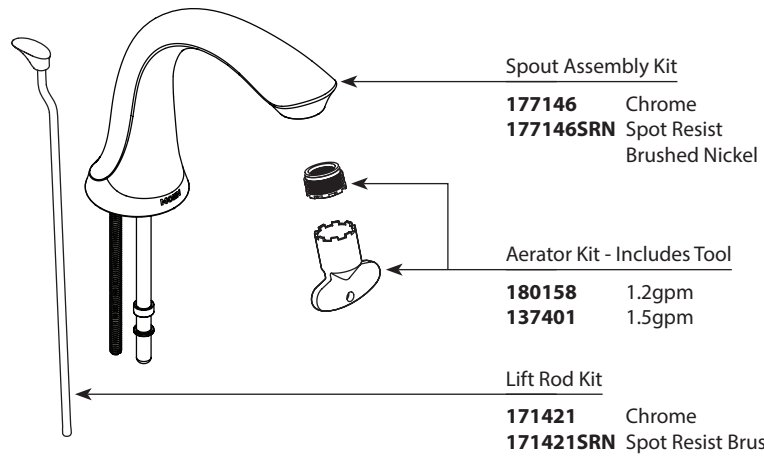
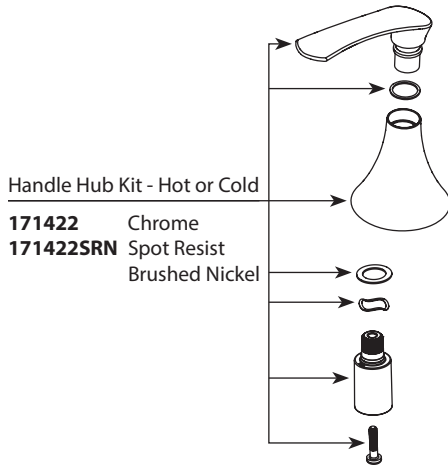

**WASTE ASSEMBLIES**

*For Waste Service Order Full Assembly*

Non-Metallic Waste Assembly

**151018CSL** Classic Stainless  
(Use for Spot Resist  
Brushed Nickel)

■ Order by Part Number

DARCY™ Two-Handle Widespread Lavatory Faucet		
MODEL	FINISH	NOTES
84551	Chrome	Non-Metallic Waste
84551SRN	Spot Resist Brushed Nickel	Non-Metallic Waste

Handle Hub Kit - Hot or Cold

**171422** Chrome  
**171422SRN** Spot Resist Brushed Nickel

Spout Assembly Kit

**177146** Chrome  
**177146SRN** Spot Resist Brushed Nickel

Aerator Kit - Includes Tool

**180158** 1.2gpm  
**137401** 1.5gpm

Lift Rod Kit

**171421** Chrome  
**171421SRN** Spot Resist Brushed Nickel

Stem Extension Kit

**174290**

Hardware Kit

**146190**

Replacement Cartridge

**1234**

**Mounting Nut**

For models prior to 8/2018

Mounting Hardware

**103759**

Hardware Package

**12715**

Valve Body Kit

**174292** Hot  
**174291** Cold

Duralock Hose Kit

**114299**

**WASTE ASSEMBLIES**

Waste Plug

**12314** Chrome

Waste Assembly (Obsolete)

**139246** Chrome  
**139246CSL** Classic Stainless (Use for Spot Resist Brushed Nickel)

**OBSELETE**

Spout Assembly Kit

**171423** Chrome  
**171423SRN** Spot Resist Brushed Nickel

**NOTE:** Use 177146 and 146190 or 177146SRN and 146190 as a replacement.

■ Order by Part Number

DARCY™ Two-Handle Widespread Lavatory Faucet		
MODEL	FINISH	NOTES
84551	Chrome	Non-Metallic Waste
84551SRN	Spot Resist Brushed Nickel	Non-Metallic Waste

