



Buy it for looks. Buy it for life.®

■ Order by Part Number

*There is more than 1 version of this model.  
Page down to identify the version you have.*

• 2nd generation valve manufactured on and after July 27th, 2009. Can be identified by mounting plate and smaller drive feature (1-1/8") on adapter nut.

• 147210 volume control cartridge will not work with 1st generation valves.

# Illustrated Parts

<p><b>ExactTemp®</b> <b>3/4" Volume Control Flow Valve</b></p> <p><b>MODEL</b> 3600</p>
---

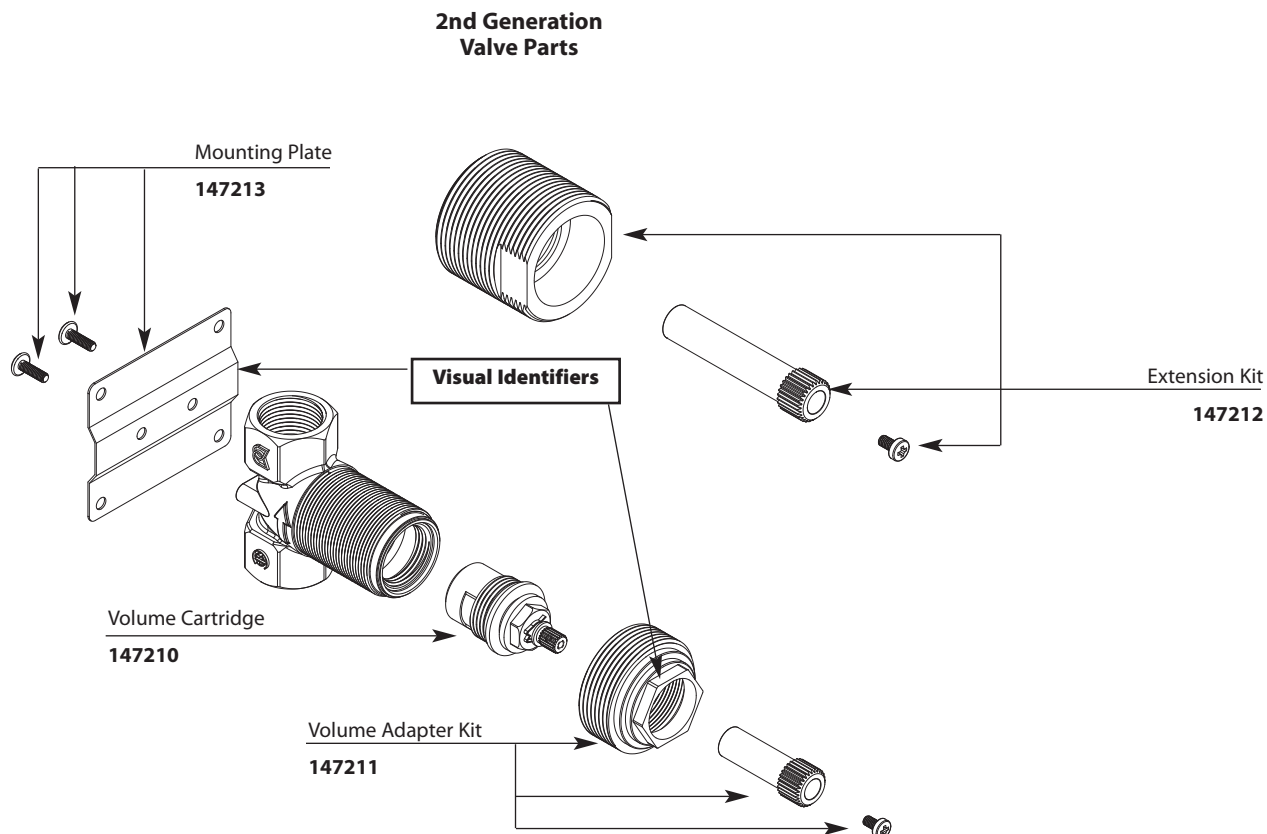



Buy it for looks. Buy it for life.®

# Illustrated Parts

## ■ Order by Part Number

- 1st generation valves manufactured prior to July 27th, 2009. Valves can be identified by a lack of a mounting bracket and drive feature on adapter nut (requires open ended wrench).
- 130157 volume control cartridge will not work with 2nd generation valves.

**ExactTemp®  
3/4" Volume Control Flow Valve**

**MODEL**  
3600

### 1st Generation Valve Parts

